



**SELLER'S PROPERTY
DISCLOSURE STATEMENT**

This form approved by the Minnesota Association of REALTORS®, which disclaims any liability arising out of use or misuse of this form. © 2007 Minnesota Association of REALTORS®, Edina, MN

- 1. Date _____
- 2. Page 1 of _____ pages

3. THE INFORMATION DISCLOSED IS GIVEN TO THE BEST OF SELLER'S KNOWLEDGE.

4. **NOTICE:** This Disclosure Statement satisfies the disclosure requirements of MN Statutes 513.52 through 513.60.
 5. Under Minnesota law, Sellers of residential property, with limited exceptions listed on page nine (9); are obligated to
 6. disclose to prospective Buyers all material facts of which Seller is aware that could adversely and significantly affect
 7. an ordinary Buyer's use or enjoyment of the property or any intended use of the property of which Seller is aware.
 8. MN Statute 513.58 requires Seller to notify Buyer in writing as soon as reasonably possible, but in any event
 9. before closing, if Seller learns that Seller's disclosure was inaccurate. Seller has disclosure alternatives allowed
 10. by MN Statutes. See *Seller's Disclosure Alternatives* form for further information regarding disclosure alternatives. This
 11. disclosure is not a warranty or a guarantee of any kind by Seller or licensee representing or assisting any party in the
 12. transaction.

13. **INSTRUCTION TO BUYER:** Buyers are encouraged to thoroughly inspect the property personally or have it inspected
 14. by a third party, and to inquire about any specific areas of concern. **NOTE:** If Seller answers NO to any of the questions
 15. listed below, it does not necessarily mean that it does not exist on the property. NO may mean that Seller is unaware
 16. that it exists on the property.

17. **INSTRUCTIONS TO SELLER:** (1) Complete this form yourself. (2) Consult prior disclosure statement(s) and/or
 18. inspection report(s) when completing this form. (3) Describe conditions affecting the property to the best of your
 19. knowledge. (4) Attach additional pages, with your signature, if additional space is required. (5) Answer all questions.
 20. (6) If any items do not apply, write "NA" (not applicable).

21. Property located at 1000 OLD LONG LAKE RD
 22. City of OROND, County of HENNERIN, State of Minnesota.

23. A. GENERAL INFORMATION:

24. (1) When did you **Acquire** **Build** the home? 1-31-09
(Check one.)

25. (2) Type of title evidence: Abstract Registered (Torrens)

26. Location of Abstract: _____

27. To your knowledge, is there an existing Owner's Title Insurance Policy? Yes No

28. (3) Have you occupied this home continuously for the past 12 months? Yes No

29. If "No," explain: _____

30. (4) Is the home suitable for year-round use? Yes No

31. (5) To your knowledge, is the property located in a designated flood plain? Yes No

32. (6) Are you in possession of prior seller's disclosure statement(s)? (If "Yes," please attach.) Yes No **NA**

33. (7) Is the property located on a public or a private road? Public Private

34. Are you aware of any
 35. (8) encroachments? Yes No

36. (9) association, covenants, historical registry, reservations or restrictions that affect or
 37. may affect the use or future resale of the property? Yes No

38. (10) easements, other than utility or drainage easements? Yes No

39. (11) Comments: _____

40. _____

41. **ORIGINAL COPY TO LISTING BROKER; COPIES TO SELLER, BUYER, SELLING BROKER.**



SELLER'S PROPERTY DISCLOSURE STATEMENT

43. THE INFORMATION DISCLOSED IS GIVEN TO THE BEST OF SELLER'S KNOWLEDGE.

44. Property located at 1000 OLD LONG LAKE RD

45. B. GENERAL CONDITION: To your knowledge, have any of the following conditions previously existed or do they
46. currently exist?

47. (1) Has there been any damage by wind, fire, flood, hail or other cause(s)? [] Yes [X] No

48. If "Yes," give details of what happened and when:

49. _____

50. _____

51. _____

52. (2) (a) Has/Have the structure(s) been altered? [] Yes [X] No
53. (e.g., additions, altered roof lines, changes to load-bearing walls)

54. If "Yes," please specify what was done, when and by whom (owner or contractor):

55. _____

56. _____

57. _____

58. (b) Has any work been performed on the property? (e.g., additions to the property, wiring, plumbing,
59. retaining wall, general finishing.) [] Yes [] No

60. If "Yes," please explain: YES. LOWER LEVEL BATH COMPLETED,

61. EXERCISE ROOM COMPLETED, THEATRE

62. ROOM FLOOR ELEVATED

63. _____

64. (c) Were appropriate permits pulled for any work performed on the property? [X] Yes [] No

65. (3) Has there been any damage to flooring or floor covering? [] Yes [X] No

66. If "Yes," give details of what happened and when:

67. _____

68. _____

69. _____

70. (4) Are you aware of any insect/animal/pest infestation? [] Yes [X] No

71. (5) Do you have or have you previously had any pets? [X] Yes [] No

72. If "Yes," indicate type CATS and number 2

73. (6) Comments:

74. _____

75. _____

76. _____

77. ORIGINAL COPY TO LISTING BROKER; COPIES TO SELLER, BUYER, SELLING BROKER.



SELLER'S PROPERTY DISCLOSURE STATEMENT

79. THE INFORMATION DISCLOSED IS GIVEN TO THE BEST OF SELLER'S KNOWLEDGE.

80. Property located at 1000 OLD LONG LAKE RD

81. C. STRUCTURAL SYSTEMS: To your knowledge, have any of the following conditions previously existed or do they
82. currently exist?

83. (ANSWERS APPLY TO ALL STRUCTURES, SUCH AS GARAGE AND OUTBUILDINGS.)

84. (1) THE BASEMENT, CRAWLSPACE, SLAB:

- 85. (a) cracked floor/walls [] Yes [X] No (e) leakage/seepage [] Yes [X] No
86. (b) drain tile problem [] Yes [X] No (f) sewer backup [] Yes [X] No
87. (c) flooding [] Yes [X] No (g) wet floors/walls [] Yes [X] No
88. (d) foundation problem [] Yes [X] No (h) other [] Yes [X] No

89. Give details to any questions answered "Yes":
90.
91.
92.
93.
94.
95.
96.
97.
98.

99. (2) THE ROOF: To your knowledge,

- 100. (a) what is the age of the roofing material? 1 1/2 years
101. (b) has there been any interior or exterior damage? [] Yes [X] No
102. (c) has there been interior damage from ice buildup? [] Yes [X] No
103. (d) has there been any leakage? [] Yes [X] No
104. (e) have there been any repairs or replacements made to the roof? [] Yes [X] No

105. Give details to any questions answered "Yes":
106.
107.
108.
109.
110.
111.
112.
113.
114.

115. ORIGINAL COPY TO LISTING BROKER; COPIES TO SELLER, BUYER, SELLING BROKER.

117. THE INFORMATION DISCLOSED IS GIVEN TO THE BEST OF SELLER'S KNOWLEDGE.

118. Property located at 1000 OLD LONG LAKE RD

119. D. APPLIANCES, HEATING, PLUMBING, ELECTRICAL AND OTHER MECHANICAL SYSTEMS:

120. **NOTE:** This section refers only to the working condition of the following items. Answers apply to all such
 121. items unless otherwise noted in comments below. Personal property is included in the sale **ONLY IF**
 122. specifically referenced in the *Purchase Agreement*.

123. Cross out only those items not physically located on the property.

	In Working Order			In Working Order			In Working Order	
	Yes	No		Yes	No		Yes	No
126. Air-conditioning	<input checked="" type="checkbox"/>	<input type="checkbox"/>	Heating system (central)	<input checked="" type="checkbox"/>	<input type="checkbox"/>	TV antenna system	<input type="checkbox"/>	<input type="checkbox"/>
127. <input checked="" type="checkbox"/> Central <input type="checkbox"/> Wall <input type="checkbox"/> Window			Heating system (supplemental)	<input checked="" type="checkbox"/>	<input type="checkbox"/>	TV cable system	<input checked="" type="checkbox"/>	<input type="checkbox"/>
128. Air exchange system	<input checked="" type="checkbox"/>	<input type="checkbox"/>	Incinerator	<input type="checkbox"/>	<input type="checkbox"/>	TV satellite dish	<input type="checkbox"/>	<input type="checkbox"/>
129. Ceiling fan	<input checked="" type="checkbox"/>	<input type="checkbox"/>	Intercom	<input type="checkbox"/>	<input type="checkbox"/>	<input type="checkbox"/> Rented <input type="checkbox"/> Owned		
130. Dishwasher	<input checked="" type="checkbox"/>	<input type="checkbox"/>	Lawn sprinkler system	<input checked="" type="checkbox"/>	<input type="checkbox"/>	TV satellite receiver	<input type="checkbox"/>	<input type="checkbox"/>
131. Doorbell	<input checked="" type="checkbox"/>	<input type="checkbox"/>	Microwave	<input checked="" type="checkbox"/>	<input type="checkbox"/>	<input type="checkbox"/> Rented <input type="checkbox"/> Owned		
132. Drain tile system	<input checked="" type="checkbox"/>	<input type="checkbox"/>	Plumbing	<input checked="" type="checkbox"/>	<input type="checkbox"/>	Washer	<input checked="" type="checkbox"/>	<input type="checkbox"/>
133. Dryer	<input checked="" type="checkbox"/>	<input type="checkbox"/>	Pool and equipment	<input type="checkbox"/>	<input type="checkbox"/>	Water heater	<input checked="" type="checkbox"/>	<input type="checkbox"/>
134. Electrical system	<input checked="" type="checkbox"/>	<input type="checkbox"/>	Range/oven	<input checked="" type="checkbox"/>	<input type="checkbox"/>	Water treatment system	<input type="checkbox"/>	<input type="checkbox"/>
135. Exhaust system	<input checked="" type="checkbox"/>	<input type="checkbox"/>	Range hood	<input checked="" type="checkbox"/>	<input type="checkbox"/>	<input type="checkbox"/> Rented <input checked="" type="checkbox"/> Owned		
136. Fire sprinkler system	<input type="checkbox"/>	<input type="checkbox"/>	Refrigerator	<input checked="" type="checkbox"/>	<input type="checkbox"/>	Windows	<input checked="" type="checkbox"/>	<input type="checkbox"/>
137. Fireplace	<input checked="" type="checkbox"/>	<input type="checkbox"/>	Security system	<input checked="" type="checkbox"/>	<input type="checkbox"/>	Window treatments	<input checked="" type="checkbox"/>	<input type="checkbox"/>
138. Fireplace mechanisms	<input checked="" type="checkbox"/>	<input type="checkbox"/>	<input type="checkbox"/> Rented <input checked="" type="checkbox"/> Owned			Wood-burning stove	<input type="checkbox"/>	<input type="checkbox"/>
139. Furnace humidifier	<input checked="" type="checkbox"/>	<input type="checkbox"/>	Smoke detectors (battery)	<input type="checkbox"/>	<input type="checkbox"/>	Other	<input type="checkbox"/>	<input type="checkbox"/>
140. Freezer	<input checked="" type="checkbox"/>	<input type="checkbox"/>	Smoke detectors (hardwired)	<input checked="" type="checkbox"/>	<input type="checkbox"/>	Other	<input type="checkbox"/>	<input type="checkbox"/>
141. Garage door opener (GDO)	<input checked="" type="checkbox"/>	<input type="checkbox"/>	Solar collectors	<input type="checkbox"/>	<input type="checkbox"/>	Other	<input type="checkbox"/>	<input type="checkbox"/>
142. Garage auto reverse	<input checked="" type="checkbox"/>	<input type="checkbox"/>	Sump pump	<input checked="" type="checkbox"/>	<input type="checkbox"/>	Other	<input type="checkbox"/>	<input type="checkbox"/>
143. GDO remote	<input checked="" type="checkbox"/>	<input type="checkbox"/>	Toilet mechanisms	<input checked="" type="checkbox"/>	<input type="checkbox"/>	Other	<input type="checkbox"/>	<input type="checkbox"/>
144. Garbage disposal	<input checked="" type="checkbox"/>	<input type="checkbox"/>	Trash Compactor	<input type="checkbox"/>	<input type="checkbox"/>	Other	<input type="checkbox"/>	<input type="checkbox"/>

145. Comments: HOT TUB IN WORKING ORDER (NEW), WHOLE HOUSE
 146. GENERATOR IN WORKING ORDER, PAID HEATERS IN
 147. WORKING ORDER.

148. E. PRIVATE SEWER SYSTEM DISCLOSURE:

149. (A private sewer system disclosure is required by MN Statute 115.55.)
 150. (Check appropriate box.)

- 151. Seller does not know of a private sewer system on or serving the above-described real property.
- 152. There is a private sewer system on or serving the above-described real property.
- 153. (See *Private Sewer System Disclosure Statement*.)
- 154. There is an abandoned private sewer system on the above-described real property.
- 155. (See *Private Sewer System Disclosure Statement*.)

156. **ORIGINAL COPY TO LISTING BROKER; COPIES TO SELLER, BUYER, SELLING BROKER.**



SELLER'S PROPERTY DISCLOSURE STATEMENT

158. THE INFORMATION DISCLOSED IS GIVEN TO THE BEST OF SELLER'S KNOWLEDGE.

159. Property located at _____

160. F. PRIVATE WELL DISCLOSURE: (A well disclosure and Certificate are required by MN Statute 1031.235.)

161. (Check appropriate box.)

162. [] Seller certifies that Seller does not know of any wells on the above-described real property.

163. [X] Seller certifies there are one or more wells located on the above-described real property.

164. (See Well Disclosure Statement.)

165. Are there any wells serving the above-described property that are not located on the property? [] Yes [X] No

166. To your knowledge, is this property in a Special Well Construction Area? [] Yes [X] No

167. G. PROPERTY TAX TREATMENT:

168. Valuation Exclusion Disclosure (Required by MN Statute 273.11, Subd. 16.)

169. (Check appropriate box.)

170. There [] IS [X] IS NOT an exclusion from market value for home improvements on this property. Any (Check one.)

171. valuation exclusion shall terminate upon sale of the property, and the property's estimated market value for
172. property tax purposes shall increase. If a valuation exclusion exists, Buyers are encouraged to look into the
173. resulting tax consequences.

174. Additional comments: _____

175. Preferential Property Tax Treatment

176. Is the property subject to any preferential property tax status or any other credits affecting the property which

177. would terminate upon the sale of the property? [] Yes [X] No

178. (e.g., Disability, Green Acres, CRP, RIM)

179. If "Yes," please explain: _____

180. _____

181. H. METHAMPHETAMINE PRODUCTION DISCLOSURE:

182. (A Methamphetamine Production Disclosure is required by MN Statute 152.0275, Subd. 2 (m).)

183. [X] Seller is not aware of any methamphetamine production that has occurred on the property.

184. [] Seller is aware that methamphetamine production has occurred on the property.

185. (See Methamphetamine Production Disclosure Statement.)

186. I. NOTICE REGARDING AIRPORT ZONING REGULATIONS: The property may be in or near an airport safety

187. zone with zoning regulations adopted by the governing body that may affect the property. Such zoning regulations

188. are filed with the county recorder in each county where the zoned area is located. If you would like to determine

189. if such zoning regulations affect the property, you should contact the county recorder where the zoned area is

190. located.

191. J. CEMETERY ACT:

192. MN Statute 307.08 prohibits any damage or illegal molestation of human remains, burials or cemeteries. A person

193. who intentionally, willfully and knowingly destroys, mutilates, injures, disturbs or removes human skeletal remains

194. or human burial grounds is guilty of a felony.

195. To your knowledge, are you aware of any human remains, burials or cemeteries located

196. on the property? [] Yes [X] No

197. If "Yes," please explain: _____

198. _____

199. All unidentified human remains or burials found outside of platted, recorded or identified cemeteries and in contexts

200. which indicate antiquity greater than 50 years shall be dealt with according to the provisions of MN Statute 307.08,

201. Subd. 7.

202. ORIGINAL COPY TO LISTING BROKER; COPIES TO SELLER, BUYER, SELLING BROKER.

204. THE INFORMATION DISCLOSED IS GIVEN TO THE BEST OF SELLER'S KNOWLEDGE.

205. Property located at 1000 OLD LONG LAKE RD

206. K. ENVIRONMENTAL CONCERNS:

207. To your knowledge, have any of the following environmental concerns previously existed or do they currently exist
208. on the property?

- | | | | | | |
|------------------------------------|------------------------------|--|----------------------------|------------------------------|--|
| 209. Asbestos? | <input type="checkbox"/> Yes | <input checked="" type="checkbox"/> No | Mold? | <input type="checkbox"/> Yes | <input checked="" type="checkbox"/> No |
| 210. Diseased trees? | <input type="checkbox"/> Yes | <input checked="" type="checkbox"/> No | Radon? | <input type="checkbox"/> Yes | <input checked="" type="checkbox"/> No |
| 211. Formaldehyde? | <input type="checkbox"/> Yes | <input checked="" type="checkbox"/> No | Soil problems? | <input type="checkbox"/> Yes | <input checked="" type="checkbox"/> No |
| 212. Hazardous wastes/substances? | <input type="checkbox"/> Yes | <input checked="" type="checkbox"/> No | Underground storage tanks? | <input type="checkbox"/> Yes | <input checked="" type="checkbox"/> No |
| 213. Lead? (e.g., paint, plumbing) | <input type="checkbox"/> Yes | <input checked="" type="checkbox"/> No | Other? | <input type="checkbox"/> Yes | <input checked="" type="checkbox"/> No |

214. Are you aware if there are currently, or have previously been, any orders issued on the property by any governmental
215. authority ordering the remediation of a public health nuisance on the property? Yes No

216. If answer above is "Yes," seller certifies that all orders HAVE HAVE NOT been vacated.
------(Check one.)-----

217. Give details to any question answered "Yes": _____
218. _____
219. _____
220. _____
221. _____
222. _____

223. L. OTHER DEFECTS/MATERIAL FACTS:

224. Are you aware of any other material facts that could adversely and significantly affect an ordinary buyer's use or
225. enjoyment of the property or any intended use of the property? Yes No

226. If "Yes," explain below: _____
227. _____
228. _____
229. _____
230. _____
231. _____

232. M. ADDITIONAL COMMENTS:

233. _____
234. _____
235. _____
236. _____
237. _____
238. _____

239. **ORIGINAL COPY TO LISTING BROKER; COPIES TO SELLER, BUYER, SELLING BROKER.**

241. THE INFORMATION DISCLOSED IS GIVEN TO THE BEST OF SELLER'S KNOWLEDGE.

242. **N. WATER INTRUSION AND MOLD GROWTH:** Recent studies have shown that various forms of water intrusion
243. affect many homes. Water intrusion may occur from exterior moisture entering the home and/or interior moisture
244. leaving the home.

245. Examples of exterior moisture sources may be

- 246. • improper flashing around windows and doors,
- 247. • improper grading,
- 248. • flooding,
- 249. • roof leaks.

250. Examples of interior moisture sources may be

- 251. • plumbing leaks,
- 252. • condensation (caused by indoor humidity that is too high or surfaces that are too cold),
- 253. • overflow from tubs, sinks or toilets,
- 254. • firewood stored indoors,
- 255. • humidifier use,
- 256. • inadequate venting of kitchen and bath humidity,
- 257. • improper venting of clothes dryer exhaust outdoors (including electrical dryers),
- 258. • line-drying laundry indoors,
- 259. • houseplants—watering them can generate large amounts of moisture.

260. In addition to the possible structural damage water intrusion may do to the property, water intrusion may also result
261. in the growth of mold, mildew and other fungi. Mold growth may also cause structural damage to the property.
262. Therefore, it is very important to detect and remediate water intrusion problems.

263. Fungi are present everywhere in our environment, both indoors and outdoors. Many molds are beneficial to
264. humans. However, molds have the ability to produce mycotoxins that may have a potential to cause serious health
265. problems, particularly in some immunocompromised individuals and people who have asthma or allergies to
266. mold.

267. To complicate matters, mold growth is often difficult to detect, as it frequently grows within the wall structure. If you
268. have a concern about water intrusion or the resulting mold/mildew/fungi growth, you may want to consider having the
269. property inspected for moisture problems before entering into a purchase agreement or as a condition of your
270. purchase agreement. Such an analysis is particularly advisable if you observe staining or musty odors on the
271. property.

272. For additional information about water intrusion, indoor air quality, moisture or mold issues, go to the Minnesota
273. Association of REALTORS® web site at www.mnrealtor.com.

274. **ORIGINAL COPY TO LISTING BROKER; COPIES TO SELLER, BUYER, SELLING BROKER.**

276. **THE INFORMATION DISCLOSED IS GIVEN TO THE BEST OF SELLER'S KNOWLEDGE.**

277. Property located at 1000 OLD LONG LAKE RD

278. **O. NOTICE REGARDING PREDATORY OFFENDER INFORMATION:** Information regarding the predatory
279. offender registry and persons registered with the predatory offender registry under MN Statue 243.166
280. may be obtained by contacting the local law enforcement offices in the community where the property
281. is located or the Minnesota Department of Corrections at (651) 361-7200, or from the Department of
282. Corrections web site at www.corr.state.mn.us.

283. **LISTING BROKER AND LICENSEES MAKE NO REPRESENTATIONS AND ARE**
284. **NOT RESPONSIBLE FOR ANY CONDITIONS EXISTING ON THE PROPERTY.**

285. **P. SELLER'S STATEMENT:**

286. *(To be signed at time of listing.)*

287. Seller(s) hereby states the material facts as stated above are true and accurate and authorizes any licensee(s)
288. representing or assisting any party(ies) in this transaction to provide a copy of this Disclosure to any person or
289. entity in connection with any actual or anticipated sale of the property.

290. Jiminy J. [Signature] 4-27-09 [Signature] 4-27-09
(Seller) (Date) (Seller) (Date)

291. **Q. BUYER'S ACKNOWLEDGEMENT:**

292. *(To be signed at time of purchase agreement.)*

293. I/We, the Buyer(s) of the property, acknowledge receipt of this Seller's Property Disclosure Statement and agree
294. that no representations regarding material facts have been made other than those made above.

295. _____
(Buyer) (Date) (Buyer) (Date)

296. **R. SELLER'S ACKNOWLEDGMENT:**

297. *(To be signed at time of purchase agreement.)*

298. **AS OF THE DATE BELOW**, I/we, the Seller(s) of the property, state that the material facts stated above are the
299. same, **except for changes as indicated below, which have been signed and dated.**

300. _____
301. _____
302. _____
303. _____
304. _____

305. _____
(Seller) (Date) (Seller) (Date)

306. For purposes of the seller disclosure requirements of MN Statutes 513.52 through 513.60:

307. "Residential real property" or "residential real estate" means property occupied as, or intended to be occupied as, a
308. single-family residence, including a unit in a common interest community as defined in MN Statute 515B.1-103, clause
309. (10), regardless of whether the unit is in a common interest community not subject to chapter 515B.

310. The seller disclosure requirements of MN Statutes 513.52 through 513.60 apply to the transfer of any interest in
311. residential real estate, whether by sale, exchange, deed, contract for deed, lease with an option to purchase or any
312. other option.

313. **ORIGINAL COPY TO LISTING BROKER; COPIES TO SELLER, BUYER, SELLING BROKER.**

315. THE INFORMATION DISCLOSED IS GIVEN TO THE BEST OF SELLER'S KNOWLEDGE.**316. Exceptions**

317. The seller disclosure requirements of MN Statutes 513.52 through 513.60 **DO NOT** apply to

- 318. (1) real property that is not residential real property;
- 319. (2) a gratuitous transfer;
- 320. (3) a transfer pursuant to a court order;
- 321. (4) a transfer to a government or governmental agency;
- 322. (5) a transfer by foreclosure or deed in lieu of foreclosure;
- 323. (6) a transfer to heirs or devisees of a decedent;
- 324. (7) a transfer from a cotenant to one or more other cotenants;
- 325. (8) a transfer made to a spouse, parent, grandparent, child or grandchild of Seller;
- 326. (9) a transfer between spouses resulting from a decree of marriage dissolution or from a property agreement incidental to that decree;
- 327. (10) a transfer of newly constructed residential property that has not been inhabited;
- 328. (11) an option to purchase a unit in a common interest community, until exercised;
- 329. (12) a transfer to a person who controls or is controlled by the grantor as those terms are defined with respect to a declarant under section 515B.1-103, clause (2);
- 330. (13) a transfer to a tenant who is in possession of the residential real property; or
- 331. (14) a transfer of special declarant rights under section 515B.3-104.

334. Waiver

335. The written disclosure required under sections 513.52 to 513.60 may be waived if Seller and the prospective Buyer agree in writing. Waiver of the disclosure required under sections 513.52 to 513.60 does not waive, limit or abridge any obligation for seller disclosure created by any other law.

338. No Duty to Disclose

339. A. There is no duty to disclose the fact that the property

- 340. (1) is or was occupied by an owner or occupant who is or was suspected to be infected with Human Immunodeficiency Virus or diagnosed with Acquired Immunodeficiency Syndrome;
- 341. (2) was the site of a suicide, accidental death, natural death or perceived paranormal activity; or
- 342. (3) is located in a neighborhood containing any adult family home, community-based residential facility or nursing home.

345. B. **Predatory Offenders.** There is no duty to disclose information regarding an offender who is required to register under MN Statute 243.166 or about whom notification is made under that section, if Seller, in a timely manner, provides a written notice that information about the predatory offender registry and persons registered with the registry may be obtained by contacting the local law enforcement agency where the property is located or the Department of Corrections.

350. C. The provisions in paragraphs A and B do not create a duty to disclose any facts described in paragraphs A and B for property that is not residential property.

352. D. Inspections.

- 353. (i) Except as provided in paragraph (ii), Seller is not required to disclose information relating to the real property if a written report that discloses the information has been prepared by a qualified third party and provided to the prospective buyer. For purposes of this paragraph, "qualified third party" means a federal, state or local governmental agency, or any person whom Seller or prospective buyer reasonably believes has the expertise necessary to meet the industry standards of practice for the type of inspection or investigation that has been conducted by the third party in order to prepare the written report.
- 354. (ii) Seller shall disclose to the prospective buyer material facts known by Seller that contradict any information included in a written report under paragraph (i) if a copy of the report is provided to Seller.

361. THE FOLLOWING IS NOT PART OF THE MINNESOTA ASSOCIATION OF REALTORS® APPROVED FORM

362. Air Traffic to and from the Minneapolis - St. Paul International Airport may affect noise levels in the metropolitan area.
363. The Airport completed construction of a new runway in 2005. Please visit www.macnoise.com for more information
364. about aviation noise levels.

365. **ORIGINAL COPY TO LISTING BROKER; COPIES TO SELLER, BUYER, SELLING BROKER.**



WELL DISCLOSURE STATEMENT

This form approved by the Minnesota Association of REALTORS®, which disclaims any liability arising out of use or misuse of this form. © 2007 Minnesota Association of REALTORS®, Edina, MN

- 1. Date _____
- 2. Page 1 of _____ pages: THE REQUIRED MAP IS
- 3. ATTACHED HERETO AND MADE A PART HEREOF.

- 4. Minnesota Statute 1031.235 requires that, before signing an agreement to sell or transfer real property, Seller must disclose information in writing to Buyer about the status and location of all known wells on the property. This requirement is satisfied by delivering to Buyer either a statement by Seller that Seller does not know of any wells on the property, or a disclosure statement indicating the legal description and county, and a map showing the location of each well. In the disclosure statement Seller must indicate, for each well, whether the well is in use, not in use or sealed.
- 9. Unless Buyer and Seller agree to the contrary in writing, before the closing of the sale, a Seller who fails to disclose the existence or known status of a well at the time of sale, and knew or had reason to know of the existence or known status of the well, is liable to Buyer for costs relating to sealing of the well and reasonable attorneys' fees for collection of costs from Seller, if the action is commenced within six years after the date Buyer closed the purchase of the real property where the well is located.
- 14. Legal requirements exist relating to various aspects of location and status of wells. Buyer is advised to contact the local unit(s) of government, state agency or qualified professional which regulates wells for further information about these issues.

17. Instructions for completion of this form are on the reverse side.

18. PROPERTY DESCRIPTION: Street Address: 1000 Old Long Lake Rd.
Grand
 19. _____
 (City) (Zip) (County)

20. LEGAL DESCRIPTION: _____
 21. _____
 22. _____
 23. _____
 24. _____
 25. _____

26. WELL DISCLOSURE STATEMENT:
 27. (Check appropriate box.)

28. Seller certifies that Seller does not know of any wells on the above described real property.
 29. (If this option is checked, then skip to the last line and sign and date this Statement.)

30. Seller certifies that the following wells are located on the above described real property.

	MN Unique Well No.	Well Depth	Year of Const.	Well Type	IN USE	NOT IN USE	SEALED
33. Well 1	_____	_____	_____	<u>Domestic</u>	<input checked="" type="checkbox"/>	<input type="checkbox"/>	<input type="checkbox"/>
34. Well 2	_____	_____	_____	_____	<input type="checkbox"/>	<input type="checkbox"/>	<input type="checkbox"/>
35. Well 3	_____	_____	_____	_____	<input type="checkbox"/>	<input type="checkbox"/>	<input type="checkbox"/>

36. NOTE: See definition of terms "IN USE," "NOT IN USE," and "SEALED" on lines 89-100. If a well is not in use, it must be sealed by a licensed well contractor or a well owner must obtain a maintenance permit from the Minnesota Department of Health and pay an annual maintenance fee. Maintenance permits are not transferable. If a well is operable and properly maintained, a maintenance permit is not required.

41. ORIGINAL COPY TO LISTING BROKER; COPIES TO SELLER, BUYER, SELLING BROKER.



WELL DISCLOSURE STATEMENT

43. Property located at 1000 Old Long Lake Rd Cross

44. OTHER WELL INFORMATION:

45. Date well water last tested for contaminants: _____ Test results attached? Yes No

46. Comments: _____

47. _____

48. _____

49. _____

50. _____

51. _____

52. _____

53. Contaminated Well: Is there a well on the property containing contaminated water? Yes No

54. SEALED WELL INFORMATION: For each well designated as sealed above, complete this section.

55. When was the well sealed? _____

56. Who sealed the well? _____

57. Was a Sealed Well Report filed with the Minnesota Department of Health? Yes No

58. MAP: Complete the attached MAP showing the location of each well on the real property.

59. This disclosure is not a warranty of any kind by Seller(s) or any licensee(s) representing or assisting any part(ies) in
60. this transaction and is not a substitute for any inspections or warranties the party(ies) may wish to obtain.

61. CERTIFICATION BY SELLER: I certify that the information provided above is accurate and complete to the
62. best of my knowledge.

63. [Signature] 4-27-09 [Signature] 4-27-09
(Seller or Designated Representative) (Date) (Seller or Designated Representative) (Date)

64. BUYER'S ACKNOWLEDGEMENT:

65. _____ (Buyer) _____ (Date) _____ (Buyer) _____ (Date)

66. ORIGINAL COPY TO LISTING BROKER; COPIES TO SELLER, BUYER, SELLING BROKER.



WELL DISCLOSURE STATEMENT

67. Page 3

68. INSTRUCTIONS FOR COMPLETING THE WELL DISCLOSURE STATEMENT

69. **DEFINITION:** A "well" means an excavation that is drilled, cored, bored, washed, driven, dug, jetted or otherwise
70. constructed if the excavation is intended for the location, diversion, artificial recharge or acquisition of groundwater.

71. **MINNESOTA UNIQUE WELL NUMBER:** All new wells constructed AFTER January 1, 1975, should have been
72. assigned a Minnesota unique well number by the person constructing the well. If the well was constructed after this
73. date, you should have the unique well number in your property records. If you are unable to locate your unique well
74. number and the well was constructed AFTER January 1, 1975, contact your well contractor. If no unique well number
75. is available, please indicate the depth and year of construction for each well.

76. **WELL TYPE:** Use one of the following terms to describe the well type.

77. **WATER WELL:** A water well is any type of well used to extract groundwater for private or public use. Examples
78. of water wells are: domestic wells, drive-point wells, dug wells, remedial wells and municipal wells.

79. **IRRIGATION WELL:** An irrigation well is a well used to irrigate agricultural lands. These are typically
80. large-diameter wells connected to a large pressure distribution system.

81. **MONITORING WELL:** A monitoring well is a well used to monitor groundwater contamination. The well is
82. typically used to access groundwater for the extraction of samples.

83. **DEWATERING WELL:** A dewatering well is a well used to lower groundwater levels to allow for construction
84. or use of underground spaces.

85. **INDUSTRIAL/COMMERCIAL WELL:** An industrial/commercial well is a nonpotable well used to extract
86. groundwater for any nonpotable use, including groundwater thermal exchange wells (heat pumps and heat
87. loops).

88. **WELL USE STATUS:** Indicate the use status of each well. CHECK ONLY ONE (1) BOX PER WELL.

89. **IN USE:** A well is "in use" if the well is operated on a daily, regular or seasonal basis. A well in use includes
90. a well that operates for the purpose of irrigation, fire protection or emergency pumping.

91. **NOT IN USE:** A well is "not in use" if the well does not meet the definition of "in use" above and has not been
92. sealed by a licensed well contractor.

93. **SEALED:** A well is "sealed" if a licensed contractor has completely filled a well by pumping grout material
94. throughout the entire bore hole after removal of any obstructions from the well. A well is "capped" if it has
95. a metal or plastic cap or cover which is threaded, bolted or welded into the top of the well to prevent entry
96. into the well. A "capped" well is not a "sealed" well.

97. If the well has been sealed by someone other than a licensed well contractor or a licensed well sealing
98. contractor, check the well status as "not in use."

99. If you have any questions, please contact the Minnesota Department of Health, Well Management Section,
100. at (651) 201-4587 (metropolitan Minneapolis-St. Paul) or 1-800-383-9808 (greater Minnesota).

101. **ORIGINAL COPY TO LISTING BROKER; COPIES TO SELLER, BUYER, SELLING BROKER.**

ER 125-3 (07/07)



LOCATION MAP

This form approved by the Minnesota Association of REALTORS®, which disclaims any liability arising out of use or misuse of this form. © 2006 Minnesota Association of REALTORS®, Edina, MN

1. Page _____ of _____ pages

2. Please use the space below to sketch the real property being sold and, to Seller's knowledge, the approximate location of any of the following on the property.

4. PRIVATE SEWER SYSTEM WELL METHAMPHETAMINE PRODUCTION AREA
(Check all that apply.)

5. Include approximate distances from fixed reference points such as streets, buildings and landmarks.

6. Property located at 1000 Old Long Lake Rd Croton Mn

7.

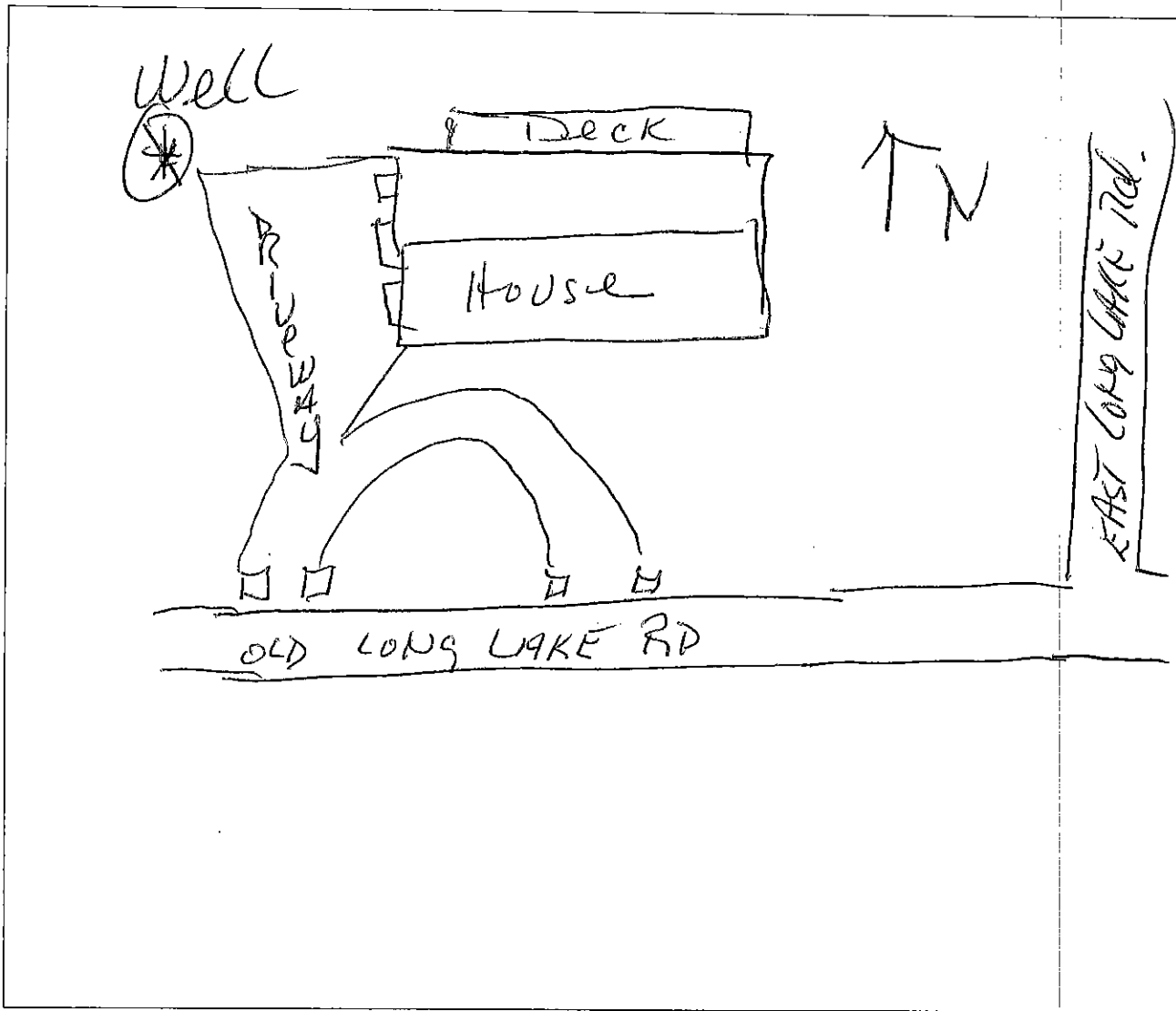

8. ATTACH ADDITIONAL SHEETS AS NEEDED.

9. Seller and Buyer initial: _____ (Seller) _____ (Date) _____ (Buyer) _____ (Date)

10. _____ (Seller) _____ (Date) _____ (Buyer) _____ (Date)

11. ORIGINAL COPY TO LISTING BROKER; COPIES TO SELLER, BUYER, SELLING BROKER